

# Heated Merchandisers

## HMR-103 Three-well system

*A unique heated merchandising system that allows the customer to choose the number of wells, the style of glass, and the combination of full-serve and self-serve heated sections.*



*Configuration shown: All full-serve with curved glass profile on white 19 in. (483 mm) Profile base.*

### Description

The Henny Penny HMR heated merchandisers are designed to give operators the ultimate in flexibility and performance. Units can combine full-serve heated modules with self-serve heated modules in virtually any configuration. In addition, four different glass profiles are available.

All full-serve modules feature Henny Penny's unique THERMA-VEC® Even Heat Process.

### Configuration

- All full-serve or all self-serve units are available in 3, 4, 5, 6, or 7 wells. (See separate Data Sheets for other sizes.)
- Full-serve and self-serve sections can be combined in modules of two or more adjacent wells to create a customized combination merchandiser of 4, 5, 6, or 7 wells.
- Four glass profiles to choose from: curved, straight, vision (matches Hussmann Vision® series), advantage (matches Tyler Advantage® series.)
- Merchandiser bases are available in Profile or Pedestal styles in several heights and colors. (See separate Data Sheet.)

### Main Features

- Easy to use controls located in top rear panel for optimal operator viewing and access.
- Independent controls over each well for upper radiant heat and food probe temperature display.
- Control settings can be locked to prevent accidental changes.
- Lower heat and water pan heat independently controlled.
- Mirrored or clear side glass. (CE units are only available with clear side glass.)
- Separate switches for power and lights.
- Exclusive THERMA-VEC® Even Heat Process holds food at precise and stable temperatures.
- Humidified operation with built-in low-water indication.
- Front glass lifts easily for cleaning and closes gently on gas springs.
- Sliding rear doors with mirrored glass can be removed from high wattage units for efficient service during peak operation.

- Brilliant halogen lamps for attractive food presentation.
- Fold-down wood or plastic cutting board.
- Units are shipped with adjustable pan supports, food temperature probes, and a water pan.

### Accessories available separately

Modular system of wire shelves and guide rails that offer "two-tier" capacity for various HMR configurations:

- Wire shelf—three-well section
- Wire shelf—two-well section
- Pan support with guide rail

**Henny Penny Corporation**  
PO Box 60  
Eaton OH 45320 USA

+1 937 456.8400  
+1 937 456.8434 Fax

**Toll free in USA**  
800 417.8417  
800 417.8434 Fax

[www.hennypenny.com](http://www.hennypenny.com)

# HMR-103 Specifications

## Glass Profiles

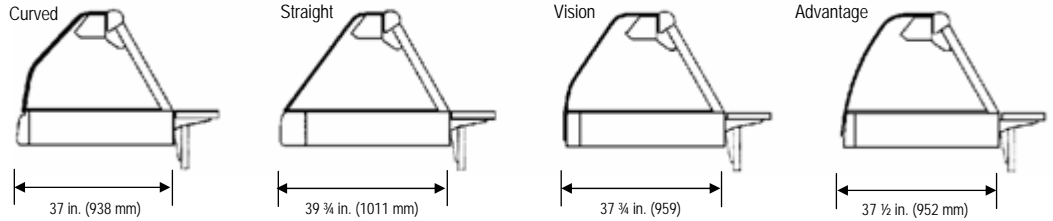

## Clearances

Rear: allow 9 in. (229 mm) for cutting board  
 Top: allow at least 15 in. (381 mm) for raising front glass.

Matches Hussmann Vision® Series refrigerated cases: NEBOH, NESDH, NEGDH, HEGDF

Matches Tyler Advantage® Series refrigerated cases: LCF-6, 8, 12 and LCM-6, 8, 12

## Dimensions

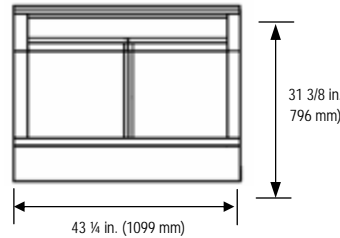

## F/S Configurations

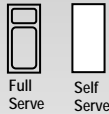

## Full-Serve Pan Capacity

Each full-serve well holds one full-size pan and one third-size pan up to 4 in. (102 mm) depth.

## Self-Serve Area

3-well section: 26 3/4 x 37 3/4 in. (679 x 1257 mm)  
 Please specify insert depth: Flat, 3/8 in. (10 mm), or 2 in. (51 mm)

## Shipping Weight

Approximately 325 lb (148 kg). Actual shipping weight will vary depending on glass profiles and F/S configurations.



## Shipping Cube Dimensions

L x W x H: 49 3/4 x 48 3/4 x 40 in. (126.4 x 123.8 x 101.6 cm)

## Listings

UL, UL Sanitation, CSA, CE

## Electrical

Config.	Volts	Phase	Watts	Amps	Wire	Plug type
3S	120/208	1	2415 or 3165	11.6 or 15.2	3+G	Power cord and plug included with the following units only, for Canada or USA destination: 120/208V 1Ph                      120/208V 3PH 120/240V 1Ph   NEMA L14-30P                      NEMA-L21-20P
	120/240	1	2415 or 3301	10.1 or 13.8	3+G	
	220-240	1	2761 or 3647	11.5 or 15.2	2+G	
	120/208	3	2415 or 3165	9.2 or 11.1	4+G	
	120/240	3	2415 or 3301	8.1 or 10.1	4+G	
3F	380-415	3	2761 or 3647	5.4 or 6.1	3NG	
	120/208	1	2991 or 3741	14.4 or 18.0	3+G	
	120/240	1	3026 or 3912	12.6 or 16.3	3+G	
	220-240	1	3373 or 4259	14.1 or 17.7	2+G	
	120/208	3	2991 or 3741	9.8 or 11.8	4+G	
120/240	3	3026 or 3912	8.7 or 10.7	4+G		
380-415	3	3373 or 4259	5.4 or 6.8	3NG		

Note: all other electrical configurations must be hardwired at installation site.

Specifications subject to change without notice. For up to date product information, please visit [www.hennypenny.com](http://www.hennypenny.com).

## Order from:

Manufactured by:

**Henny Penny Corporation**  
 PO Box 60  
 Eaton OH 45320 USA